



S12-240 AGM

Rolls 12V 215Ah (C20) Deep Cycle AGM Battery



CONSTANT CURRENT DISCHARGE (AMPS)									
CUT OFF VOLTAGE V/CELL	30M	45M	1HR	2HR	3HR	5HR	8HR	10HR	20HR
1.75V	195	148	112	63	48.2	32.1	21.6	18.4	10.75

RESERVE CAPACITY	
@25AMPS	@75 AMPS
420 Mins.	95 Mins.

SPECIFICATIONS		
Nominal Voltage		12 Volt
Rated Capacity (20 hour rate)		210Ah
Dimensions	Height	371mm
	Length	381mm
	Width	178mm
Weight		60 Kg

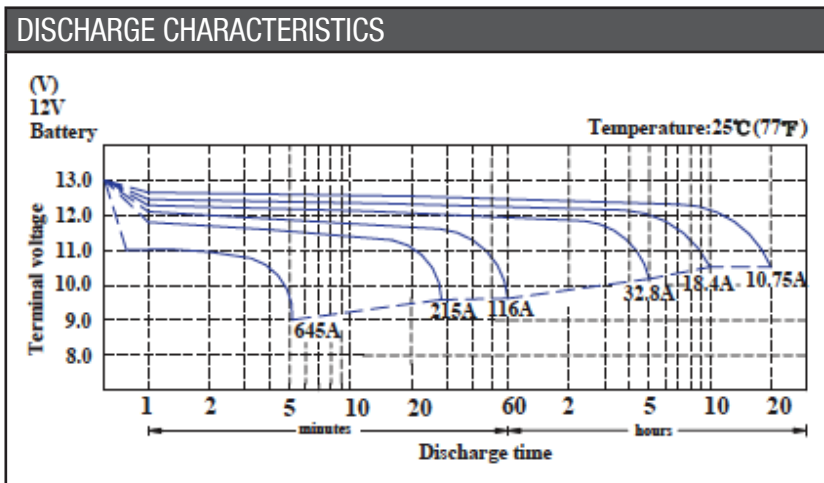

CHARACTERISTICS		
Capacity 77°F (25°C)	100 Hour Rate	240Ah
	20 Hour Rate	215Ah
	10 Hour Rate	193Ah
Internal Resistance	Full charged Battery 77°F (25°C)	2.3mΩ
Capacity Affected by Temperature (20hr rate)	104°F (40°C)	102%
	77°F (25°C)	100%
	32°F (0°C)	85%
Self Discharge 77°F (25°C)	5°F (-15°C)	65%
	Capacity after 3 month storage	91%
	Capacity after 6 month storage	82%
Capacity after 12 month storage		64%
	Max Discharge 77°F (25°C)	2000A (5s)
Terminal	Standard	DT
Charging (Constant Voltage)	Cycle	14.5 to 14.9V DC/unit Average at 25°C
	Float	13.6 to 13.8V DC/unit Average at 25°C

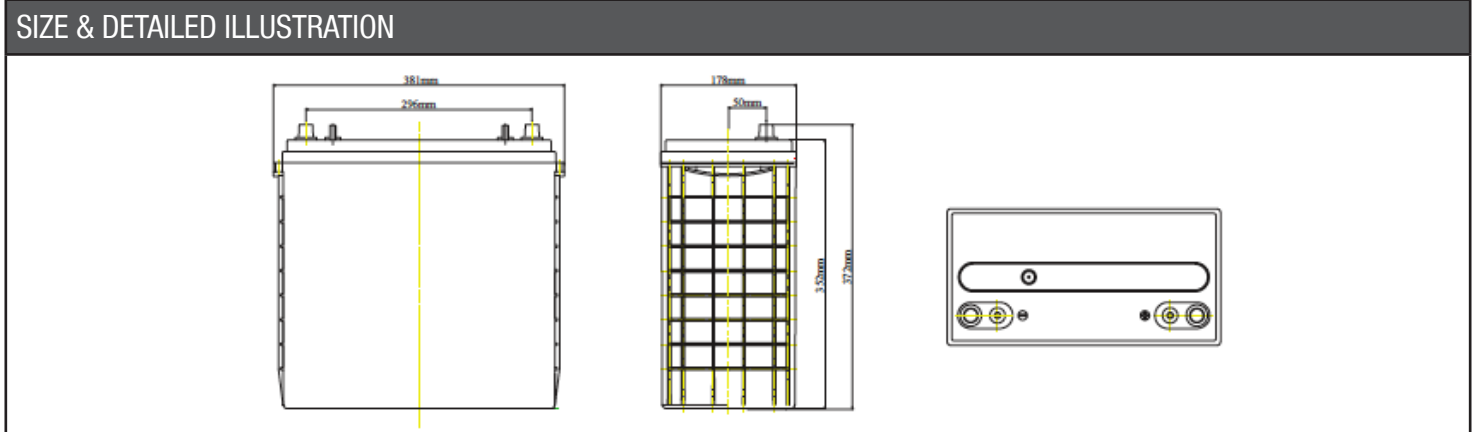

This information is generally descriptive only and is not intended to make or imply and representation, guarantee or warranty with respect to any cells and batteries. Call and battery design/specifications are subject to modifications without notice. For further information contact Rolls Battery Europe.

